

deli得力

U 过塑机 使用说明书 USER'S MANUAL

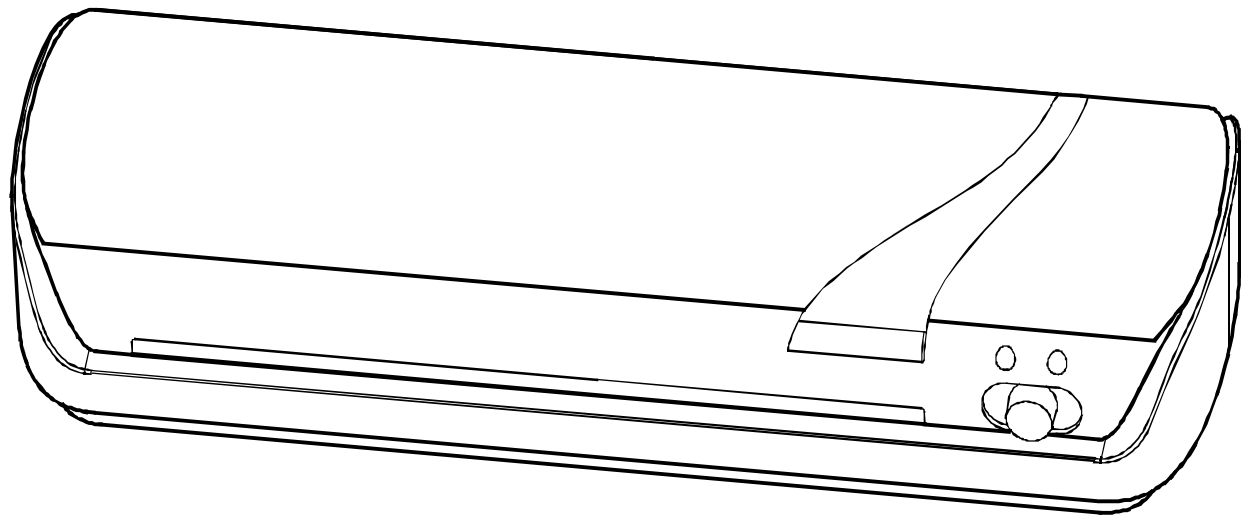

MODEL:

G220LR-001(2130)

G230LR-002(2131)

使用时注意事项	1
安全使用说明	2
产品结构及外形名称	3
塑封操作说明	4
保养与维护	4
装箱清单	5
技术参数	5
简易故障处理	6
保修及售后服务	6
Precautions for operation	7
Safety Precautions for Operation	8
Names of Product Structures and Appearance	9
Operating Instruction of Laminating	10
Protection and Maintenance	10
Packing List	11
Technical Parameters	11
Trouble Shooting	12
Guarantee and After-sale Service	12

感谢您购买得力公司生产的过塑机。同时敬请使用本公司的护卡膜(deli)。它将纸张照片过塑后，表面光洁、外观漂亮，而且抗水耐磨损。塑封后将难以开封，故请务必注意。

为了正确使用该产品，并防止给您及他人带来危害和财产损失，请仔细阅读本手册。

使用时注意事项

警告



危险，请勿让儿童使用。
※ 以免造成伤害。



危险，请勿在机器工作时，用手触摸机器进膜口。
※ 以免造成意外受伤。



危险，请勿在机器工作时，用手触摸机器表面。
※ 以免造成意外受伤。



危险，请勿在操作中将领带、项链等容易卷进机内的服饰靠近机器进膜口。
※ 以免造成意外受伤。



危险，请勿在操作中将头发等接近进膜口。
※ 以免造成意外受伤。



危险，机器在工作时，注意机器表面高温。
※ 以免造成意外受伤。



危险，请勿以任何方式自行分解改造修理机器。
※ 以免造成触电或意外受伤。万一出现物品卷入机内等故障时，请拔下电源插头，然后联系销售网点或售后服务中心，并请听从其指示行事。



危险，切勿向本机泼水。
※ 以免造成火灾或触电。



危险，请勿湿手操作本机器。
※ 以免造成触电或意外受伤。



危险，请勿损伤或加工电源线，勿在电线上放置重物。
※ 以免引起火灾或触电。



万一发生冒烟或有异臭等异常状况时，请立即切断电源，中止使用。
※ 以免引起火灾或触电。



万一在使用过程中发生停电状况时，请在短时间内匀速抽出过塑件，并拔掉电源插头。
※ 以免引起火灾或触电。



移动机器时，请务必拔下电源插头。



若机器本体或电源线有任何破损，请勿使用。
※ 以免引起火灾或触电。

安全使用说明 (为保证使用安全，请务必遵守下列注意事项)

安放场所 (1) 请勿放在潮湿及靠近空调排风口的地方，以免电线绝缘失灵出现漏电等危险事故。

(2) 请将机器安放平稳。并在塑封机出膜口一侧，留足足够的空间。

(3) 请勿在机器上放置物品。

(4) 请务必使用AC220V~240V电源。

护卡膜 (1) 本机的护卡膜适合厚度规格为50mic~125mic。建议使用本公司的护卡膜，如使用其它规格或其它不良护卡膜，有可能会被卷进机器内。

(2) 建议使用比塑封物大5~6mm的护卡膜。过大或过小都会影响塑封效果。如无大小合适的护卡膜，也可使用较大的护卡膜。按照下图(A)图示使用，夹入其它纸张，待塑封后再将其裁去。

过塑物品 过塑是通过加温、加压进行的，因操作失误，有可能出现护卡膜卷进机内的情况。为此，请勿塑封下列物品。

(1) 易燃及加热后易熔化的物品(如塑料袋等)；

(2) 只有一张的重要物品；

(3) 包括护卡膜在内，厚度在0.5mm以上的物品；

(4) 感热纸及用蜡笔绘制的图案等加热后会变色、变质的物品；

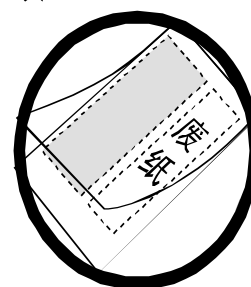

当护卡膜大小不合适时
图(A)

过塑方法

请勿用以下过塑方法：

- (1) 从护卡膜的开口侧放入使用
- (2) 将护卡膜斜放入使用
- (3) 原稿跟膜规格不符, 护卡膜空余部分太多
- (4) 原稿自身波浪形或卷曲状态
- (5) 不要前后膜连接使用
- (6) 不要把膜剪开使用
- (7) 用已变形的护卡膜进行过塑
- (8) 过塑件长度不得小于65mm

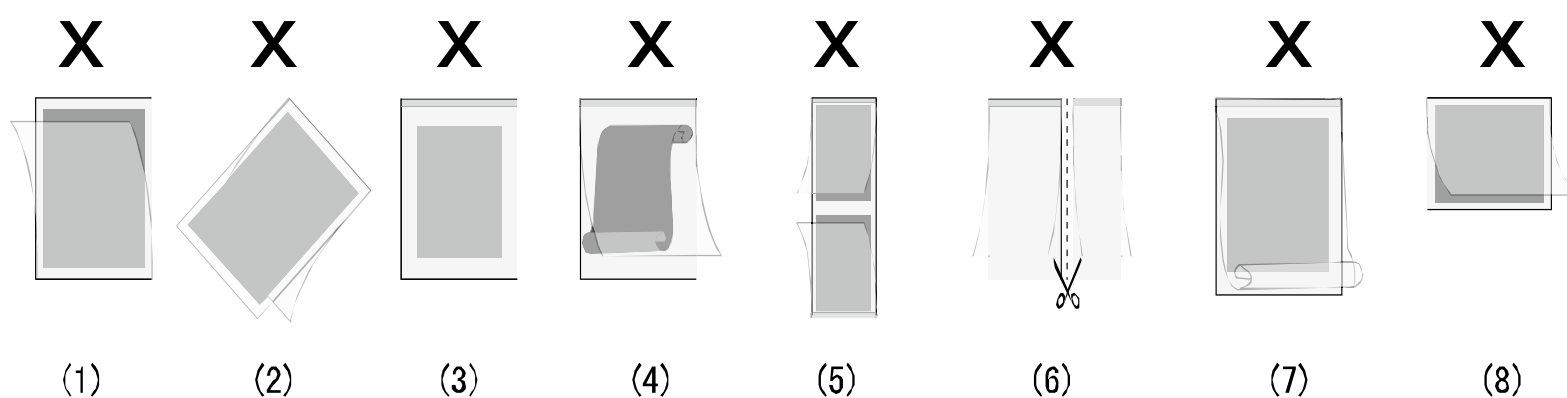

产品结构及外形名称

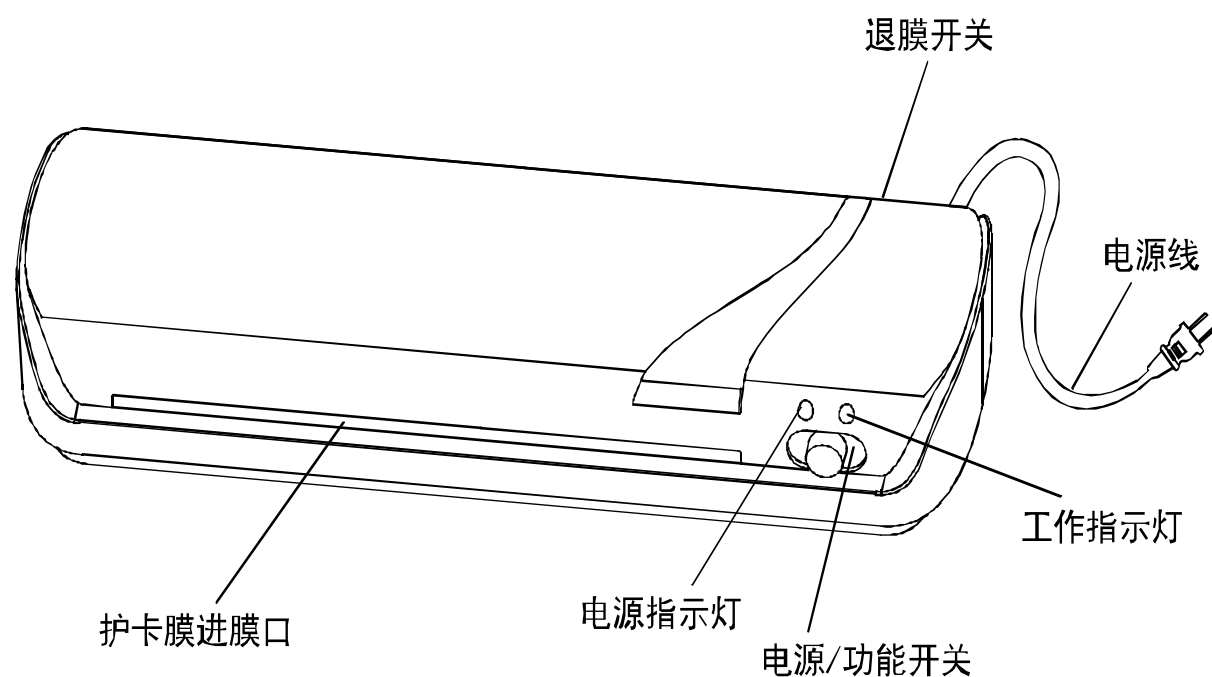

塑封操作说明

开机	接通电源线 采用热塑封的护卡膜（厚度50~125mic）
热裱	将电源功能开关拨到热裱位置，电源指示灯亮红色 机器预热3-5min左右，当工作指示灯（绿色）长亮时，可正常过塑
退膜	当遇到卡膜，膜放斜或需要退出过塑件时，可按下退膜开关（慢慢抽出护卡膜）； 松开退膜开关，则退膜开关会自动弹起为进膜状态 采用冷裱膜
冷裱	开机后需要冷裱，把电源/功能开关调节到冷裱位置后可直接过塑 如在热塑封后需冷裱，需把电源功/能开关调节到冷裱位置后空转10min后方可过塑
关机	热裱完成后把电源/功能开关调节到冷裱位置，空转冷却5-10min后， 关闭电源/功能开关，拔下电源插头

保养与维护

- (1) 胶辊清洁: 过塑机长期使用后, 胶辊上会粘上熔融的塑料残渣, 易导致护卡膜卷入机器内, 而且这些塑料残渣一旦凝固会很难清除, 因此请仔细清除。
清洁步骤: 请将日历、商品目录等中等厚的纸张不夹护卡膜, 在热裱状态过塑数次即可。
- (2) 过塑机清洗: 清洗前请拔掉电源插头, 用含少量水份的湿布擦拭, 不允许用汽油、酒精、稀释剂清洗, 更不允许用金属刷子和工具刷、铲子敲打胶辊, 以免划伤胶辊。
- (3) 机器长时间停机不用时, 请用合适的罩子将整机罩住以防灰尘。

装箱清单

序号	名称	数量	备注
1	过塑机	1台	
2	使用说明书	1份	
3	产品保修卡	1份	
4	产品合格证	1份	

技术参数

货号	No.2130	No.2131
型号	G220LR-008	G320LR-009
最大过塑宽度	220mm(A4幅面)	320mm(A3幅面)
功率	240W	330W
电压	AC220V ~240V	
最大过塑厚度	≤0.5mm(包括护卡膜厚度)	
过塑速度	230mm/min	
温度范围	85°C~145°C	
加热方式	外部加热	
噪声	≤ 55dB	
预热时间	3~5min	
产品尺寸	350x130x63mm	443x140x63mm
产品净重	1.2kg	1.5kg

进步性能改良,恕不另行通知,规格允许误差 ±5%

简易故障处理

异常现象	常见原因	处理方法
过塑件出现白雾状或在护卡膜中间出现纵向波纹上翘或撕开不粘胶。	机器温度过低或护卡膜厚度超出最大范围	机器再加热2-3分钟后过膜； 更换护卡膜（厚度在要求的范围内）
	塑封物件受潮	将塑封件干燥后再进行塑封
塑封件产生起皱（波纹）或气泡	开机时间过久，导致温度偏高	改用纸卡或作废的塑封件过一次，即可正常使用
	护卡膜厚度超出规定范围	更换成厚度在规定范围内的护卡膜
工作指示灯不亮，机器不加热	机器内加热装置已烧坏	此时须联系售后服务中心或专业电工解决
机器不工作，电源指示灯不亮	电源插头与插座接触不良	检查电源插头与插座是否接触不良
	温度保护器或保险管烧断	此时须联系售后服务中心或专业电工解决
	电源/功能开关未打开	打开电源/功能开关
电源指示灯（红色）、工作指示灯（绿色）长亮，进膜口不会自动吸入护卡膜。	过塑件未插到位	过塑件插入碰到胶棍为止
	内部传动已损坏	此时须联系售后服务中心或专业电工解决
塑封件从入口进去未从出口出来	塑封件卷进机内	马上按下退膜开关置于退膜状态
	内部传动已损坏	此时须联系售后服务中心或专业电工解决
绿灯一直不亮	绿灯已损坏	此时须联系售后服务中心或专业电工解决
	机器内加热装置已烧坏	此时须联系售后服务中心或专业电工解决

保修及售后服务

保修期内，如属正常使用情况下出现的故障，请通知当地代理店。但是由于过塑操作失误所引起的故障则不属于保修范围之内。

Thank you for buying the laminating machine of Deli Company. Please use the laminating film (trade mark: **deLi**) of our company correspondingly. Paper and photos laminated by it featured smooth and clear surface, beautiful appearance as well as waterproof and wear-resistance properties. However please note it is impossible to remove the film after laminating

For correct operation of the machine and prevention of injury and damage to properties, please read this manual carefully before operating.

Precautions for Operation

Warning



Danger. Please do not let children use it.
※ To prevent body injuries.



Danger. Please do not touch the film inlet while the machine is running.
※ To prevent accidental injuries.



Danger. Please do not touch the surface of machine while it is running.
※ To prevent accidental injuries.



Danger. Please do not let such accessories as the tie, necklace etc. close to the film inlet during operation.
※ To prevent accidental injuries.



Danger. Please do not let the hair close to the film inlet during operation.
※ To prevent accidental injuries.



Danger. Attention: the surface of machine has a high temperature when the machine is running.
※ To prevent accidental injuries.



Danger. Do not disassemble, alter and repair the machine in any way on your own.
※ To prevent electric shock or accidental injuries. In case faults such as products rolled into the machine occur, please pull out the power plug and call distribution outlets or after-sale service center. Do in accordance with their instructions.



Danger. Do not water the machine.
※ To prevent fire or electric shock.



Danger. Do not operate the machine with wet hands.
※ To prevent electric shock or accidental injuries.



Danger. Do not break or process the power wire and do not put heavy products on the wire.
※ To prevent fire or accidental injuries.



In case abnormal situations happen including fuming or having unpleasant smell and so on, please cut off the electricity and stop operating.

※ To prevent fire or electric shock.



In case the power is off during operation, please take out the laminated object immediately and pull out the power plug.

※ To prevent fire and electric shock.



Please do not forget to pull out the power plug before moving the machine.



Please do not use it if there is any damage of the machine or the power wire.

※ To prevent fire or electric shock.

Safety Precautions for Operation

(Please observe the following instructions to make sure a safe operation.)

- Places
- (1) To prevent such accidents of electric leakage and so on caused by isolation failure, do not place it in wet areas and places close to outlet of air conditioner.
 - (2) Please place the machine steadily and leave sufficient space to the film eject of laminating machine.
 - (3) Do not put heavy products on the machine.
 - (4) Please use electric power of AC220V-240V.

- Laminating Film
- (1) The suitable thickness of the laminating film is 80mic~200mic. We suggest using the film of our company. Films of other specifications or poor qualities may be rolled into the machine.
 - (2) It is suggested that the laminating film should be 5~6mm larger than the object being laminated. Too large or too small film may affect the laminating result. If no suitable laminating film is available, use bigger one. Do as what the following figure shows. Insert other paper and cut the superfluous part after laminated.

The Laminating of the object is carried out through heating and adding pressure. Inappropriate operation may make the laminating film rolled into the machine. Therefore, please do not laminate the following cause .

- (1) Products which are flammable and liable to be melted after heated (such as plastic bags, etc.);
- (2) Important objects which only have one copy;
- (3) Products with thickness over 0.6mm, including the thickness of the laminating film;
- (4) Objects whose colors and quality may be changed after heated, such as thermal paper and pictures with patterns drawn by crayons;

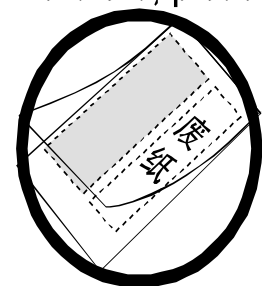

When the laminating film doesn't fit
Figure (A)

Laminating Methods

DO NOT adopt the following laminating methods:

- (1) Put the open side of the laminating film in the machine.
- (2) Put the laminating film into use in a tilted position
- (3) The size of originals swaller than film
- (4) The original is rippled or curled.
- (5) Use two pieces of film successively.
- (6) Cut film for laminating.
- (7) Use deformed film for laminating.
- (8) The length of originals can't less than 65mm.

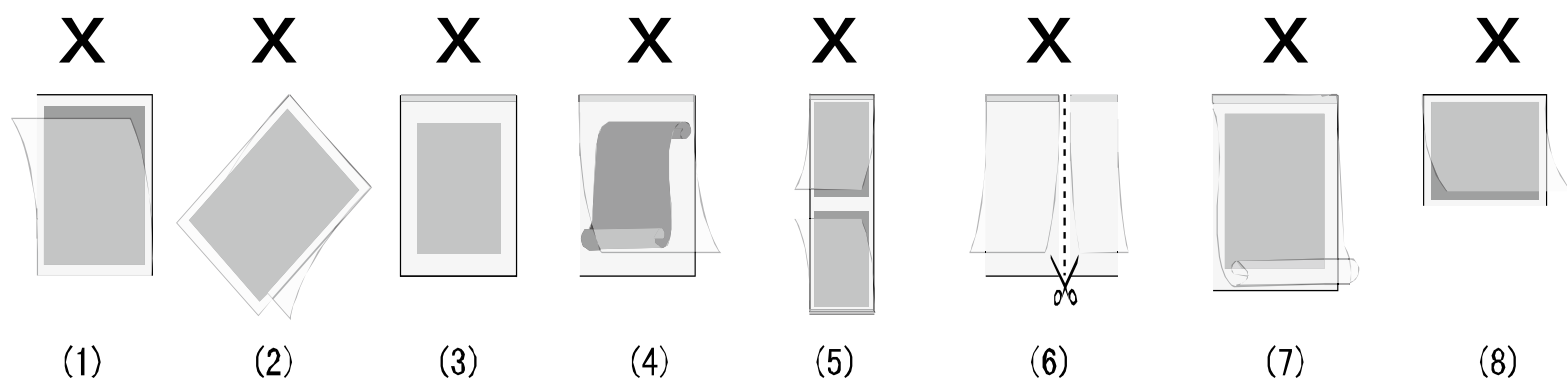

Product Structure and Appearance

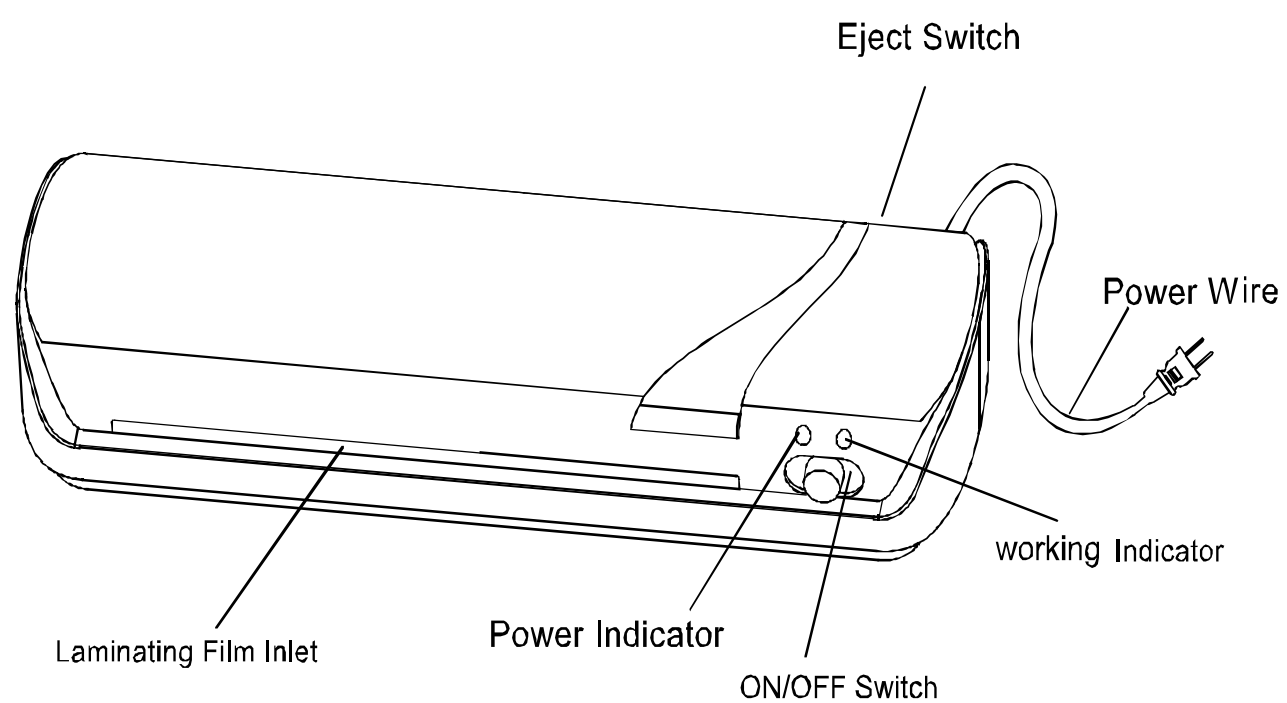

Operating Instruction of Laminating

Turn on	Connect the power plug
	Open the back guide plate which is also the way to power on(the power switch hidden inside turns on automatically).
Hot laminating	If hot plastic cement is needed, adopt hot laminating film(50-125mic).
	Turn the temperature adjusting knob to the position of hot laminating,the power indicator will on in red After about 7mins' for preheating the green heating indicator lightens and stops flashing, indicating that it finishes preheating and is ready for laminating.
Rejceting film	When laminated objects are rolled into the machine ,or if the objects is tilted, or if you need to remove the objects from the machine, pls press the eject button, the inversion lock will pop up automatically, the machine is in inverse mode, you can start removing the object. When pressing the inversion lock, the back button will pop up automatically ,and the machine is in forward mode.
Cool laminating	If cool laminating is needed, adopt cool laminating film.
	Turn the temperature adjusing knob to the position of the cool laminating and begin to laminating directly. If cool laminating is needed after the hot laminating for aperiod of time, Turn the temperature adjusting knod to the position of the cool laminating arrowhead and begin to laminate only after the machine running without laminating object for 10min.
Turn off	After hot laminating Turn the temperature adjusting knob to the position of the cool laminating after cooling 5 to 10 mins,then close the back guide plate,pull off the plug. if after cool laminating can close the back guide and pull off the plug directly.

Protection and Maintenance

- (1) Clean the rubber roller: after being used for a long time, melted plastic leavings will be adhered on the rubber roller, which is liable to make laminating film roll into the machine. In addition, these leavings are hard to be removed once they become solid. Therefore, please clean the rubber roller carefully. Cleaning procedures: laminate paper with medium thickness, such as calendar, catalog and so on, at the highest temperature grade many times without laminating film.
- (2) Clean the laminating machine: pull out the power plug before cleaning. Clean it with slightly wet cloth. Do not use gasoline, alcohol and thinner to clean the machine. Do not to use metal brush, tool brush and scoop to knock the rubber roller which may damage the roller.
- (3) Please use proper hood to cover the machine to keep away from dust if the machine won't be used for a long time.

Packing List

No.	Name	Quantity	Remark
1	Laminating Machine	One set	
2	Instruction Manual	One copy	
3	Warranty Card	One copy	
4	Quality Certificate	One copy	

Technical Parameters

Product No	No.2130	No.2131
Model No	G220LR-008	G320LR-009
Max lamination width of Laminating	220mm(A4幅面)	320mm(A3幅面)
Power	240W	330W
Voltage	AC220V ~240V	
Max lamination thickness for Laminating	≤ 0.5mm (including the thickness of film)	
Laminating Speed	230mm/min	
Temperature Range	85°C~145°C	
Heating Method	Heating outside	
Noise	≤ 5dB	
Time for Pre-heating	3~5min	
Product Size	350x130x63mm	443x140x63mm
Net Weight	1.2kg	1.5kg

We won't issue additional notices for improvements of properties. 5% more or less of the described data allowed.

Trouble Shooting

Abnormal Phenomena	Reasons	Treatments
Laminated objects are wrapped by white fog, or upward vertical ripples are appearing on the laminating film or the adhesive tape breaks away from its original	Machine temperate is too low, or the thickness of the laminating film is out of the maximum rated film thickness.	Laminator should be warmed up for 2-3mins more then laminating, again changing the film thickness to the right film(consistent with the rated film thickness.)
	Laminated objects are affected by damp	Laminate objects when they are dried.
Laminated objects are crumpled up (with ripples) or are full of air bubbles	Machine temperate is too high , caused by long time of warm up. Or the thickness of the laminating film is lower than the minimum rated film thickness.	Should test with wasted film or paper first , than you can go ahead with normal laminating.Change the film with suitable thickness consistent with the rated film thickness.
Green light is flashing but the temperature does not increase	Heating device in the machine is burnt out.	Contact after-sale center or call for professional electrician
Machine stop operating, power indicator is not on	Power plug is not connected properly with the electrical outlet	Check whether power plug and the electrical outlet is properly connected
	Overheating protector or tube fuse is burnt out	Contact after-sale center or call for professional electrician
	Power switch is off.	Switch on the power
Power supply indicator (in red), working indicator (in green) always bright,insert does not automatically suck in laminating film.	Inlet/Eject button is initiated at film ejection position	Adjust the button to the inlet position
	Laminated objects are not properly installed	Laminated objects shall be inserted to the rubber roller
	Internal transmission is broken	Contact after-sale center or call for professional electrician
Laminated objects go into the inlet but do not come out of the outlet	Laminated objects are rolled into the machine	Press eject button immediately
	Internal transmission is broken	Contact after-sale center or call for professional electrician
ready light doesn't turn on	Green light has been damaged	Contact after-sales service center or professional electrician for the solution.
	Heating device inside the machine is burnt.	Contact after-sales service center or professional electrician for the solution.

Guarantee and After-sale Service

Please contact local agents for the repairing of malfunctions caused by normal operation within the guarantee period. However, guarantee does not cover malfunctions caused by misoperation of the machine.

得力集团有限公司

DELI GROUP CO., LTD.

地址: 浙江宁海得力工业园

Address: Deli Industry Zone, Ninghai County,
Zhejiang Province, China

电话 (Tel): 0574-65278888

传真 (Fax): 0574-65273660

Http://www.nbdeli.com

MADE IN CHINA



全国服务热线: 400-185-0555